

**1 CONSTRUCTION PLAN - LEVEL LL1A - SEGMENT C**  
SCALE: 1/8" = 1'-0"

**KEYNOTES**

- 069 EXISTING WALL, VERIFY LOCATION
- 073 STAINLESS STEEL LINEN DROP HINGED DOOR W/FRAME
- 075 EXISTING CORE WALLS TO REMAIN
- 080 PLASTIC LAMINATE CEILING HUNG CHANGING STALL PARTITION 12" AFF
- 081 FRAMED TEMPERED FROSTED GLASS SHOWER DOOR
- 083 PLASTIC LAMINATE COUNTER TOP W/ ADJUSTABLE SHELF BASE CABINET
- 085 COMED CONCRETE ENCASED CONDUIT
- 087 WOOD BENCH SUPPORTED WITH METAL PEDESTALS

**Metropolitan Pier and Exposition Authority**  
301 East Cermak Road, Chicago, IL 60616

**McCormick Place HQ Hotel**  
2121 South Prairie Avenue, Chicago, IL 60616

**Goettsch Partners**  
Architect  
224 South Michigan Avenue, Suite 1700, Chicago, IL 60604

**Simeone Deary Design Group**  
Interior Design  
605 North Michigan Avenue, Suite 350, Chicago, IL 60611

**Magnusson Klemencic Associates, Inc.**  
Structural Engineer  
111 South Wacker Drive, Suite 3300, Chicago, IL 60606

**F.E. Moran**  
Mechanical Design Build Contractor  
226 Carlson Drive, Northbrook, IL 60062

**Cosentini Associates**  
Electrical & Plumbing Engineer  
1060 West Division Street, Chicago, IL 60642

**Great Lakes Plumbing and Heating**  
Fire Protection Design Build Contractor  
4521 West Diversy Avenue, Chicago, IL 60639

**Gibson**  
Audio Visual, Security, & Telecommunications  
3100 Woodstock Drive, Downers Grove, IL 60515

**Moody Nolan**  
Associate Architect / LEED  
209 South LaSalle Street, Suite 820, Chicago, IL 60604

**Site Design Group, Ltd.**  
Landscape Design  
888 South Michigan Avenue, Suite 1000, Chicago, IL 60605

**Terra Engineering, Ltd.**  
Civil Engineer  
225 West Ohio Street, 4th Floor, Chicago, IL 60654

**Anne Kustner Lighting Design, Ltd.**  
Lighting Consultant  
900 Isabella Street, Evanston, IL 60201

**Catt Lyon Design + Wayfinding**  
Wayfinding / Graphics  
53 West Jackson Boulevard, Suite 362, Chicago, IL 60604

**Ricca Design Studios**  
Food Service  
5325 South Valerita Way, Greenwood Village, CO 80111

**Klein and Hoffman, Inc.**  
Structural & Masonry Engineer (for ABC Building)  
150 South Wacker Drive, Suite 1900, Chicago, IL 60606

**GENERAL NOTES**

- A. ALL WALLS OF DOCK AREA ON LEVEL 01 TO BE CMU.
- B. REFER TO SHEET A6.003 FOR REQUIRED STC RATINGS AT BALLROOM, MEETING ROOM, AND OFFICE PARTITIONS.
- C. REFER TO G3 SERIES DRAWINGS FOR EGRESS AND OCCUPANCY PLANS.
- D. SEE LANDSCAPE DRAWINGS FOR SIDEWALK SCORING COLOR AND FINISH.
- E. SEE CIVIL DRAWINGS FOR SITE ELEVATIONS, DRIVEWAY AND CURB SECTIONS, AND UTILITY INFORMATION.
- F. SEE CIVIL DRAWINGS FOR SIDEWALK HYDRANTS AND HOSE BIB LOCATIONS.
- G. SEE ELECTRICAL DRAWINGS FOR PLANTER RECEPTACLES.
- H. KITCHEN EQUIPMENT SHOWN FOR REFERENCE ONLY. REFER TO FOOD SERVICE DRAWINGS.
- I. SEE FOOD SERVICE DWGS FOR EQUIPMENT BASE LOCATIONS WHERE REQUIRED. GC TO PROVIDE CONCRETE FILL AT EQUIPMENT BASE LOCATIONS.
- J. DESIGNER/OWNER TO ENSURE ALL WALLS AND/OR CEILINGS ARE PROPERLY REINFORCED TO SUPPORT ALL WALL/CILING FOOD SERVICE EQUIPMENT. SEE FOOD SERVICE DWGS.
- K. PITCH FLOORS TO AREA DRAINS IN FOOD SERVICE AREAS. REFER TO FOOD SERVICE DWGS.
- L. REFER TO G0.401 & G0.402 FOR BACK OF HOUSE FINISH SCHEDULE. REFER TO ID DRAWINGS FOR FRONT OF HOUSE FINISH SCHEDULE.
- M. FOR INTERIOR BOH FINISHES REFER TO SHEETS G0.401 AND G0.402.
- N. PROVIDE 6" CONCRETE CURB UNDER ALL FOOD PREPARATION AREA, COMED VAULT ROOM, AND ANY WET AREA PARTITIONS.
- O. PROVIDE FIRE TREATED 2x8x3/4" PLYWOOD AS WALL PROTECTION AND STAINLESS STEEL CORNER GUARDS AT ALL SERVICE CORRIDORS.
- P. PROVIDE LADDERS AND ACCESS PANELS FOR MECHANICAL MEZZANINES AS REQUIRED. PROVIDE HATED PANELS WHERE REQUIRED.
- Q. SEE FOOD SERVICE DWGS FOR ALL REQUIRED SLAB DEPRESSIONS. COORDINATE AS REQUIRED. REFER TO A9 SERIES FOR EXTERIOR WALL AND WINDOW INFORMATION FOR ABC BUILDING.
- S. PER SPEC 104413, FIRE PROTECTION CABINETS (FCOPI) TO BE LISTED AND LABELED TO COMPLY WITH REQUIREMENTS IN ASTM E814 FOR FIRE RESISTANCE RATING OF WALLS WHERE THEY ARE INSTALLED.

**CONST. PLAN LEGEND**

- 101 DOOR REFERENCE TYPE SEE SHEET A6.200 - A6.201
- 11 WALL TYPE REFERENCE SEE SHEET A6.600
- 04 KEYNOTE REFERENCE
- INDICATES POURED CONC. CURB. SEE NOTE N

**GRAPHIC SCALES**

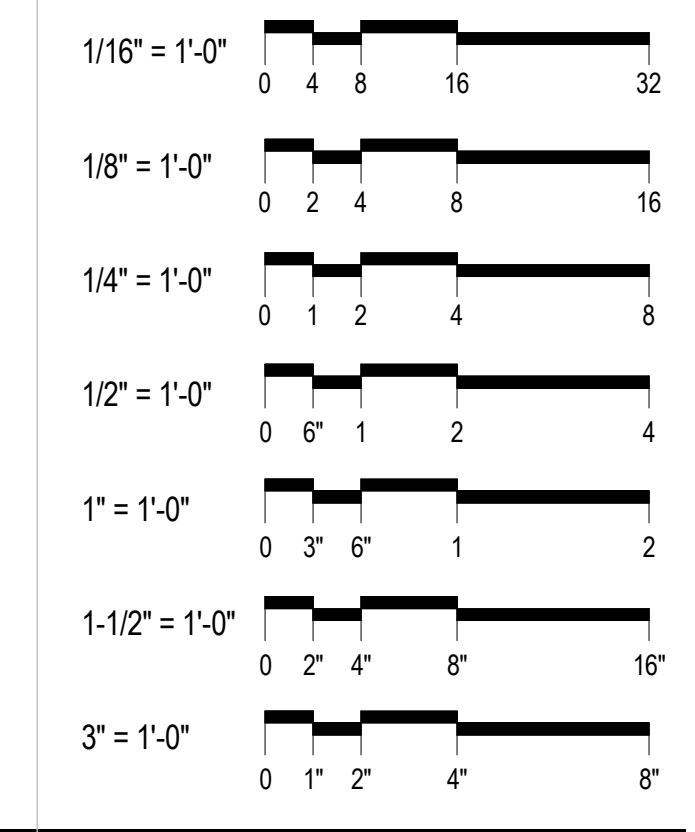

Date	Description
31 Jan 2016	ISSUED FOR 50% DD
01 Jun 2016	ISSUED FOR 50% CD
01 Aug 2016	ISSUED FOR FULL BUILDING PERMIT
15 Sep 2016	INTERIOR BID SET
07 Oct 2016	FULL BUILDING PERMIT CORRECTIONS
16 Oct 2016	ISSUED FOR 100% CD
06 Nov 2016	FULL BLDG PERMIT CORRECTIONS 2
07 Dec 2016	FULL BLDG PERMIT CORRECTIONS 3
22 Jan 2016	BULLETIN 6
25 Mar 2016	BULLETIN 6
29 Apr 2016	BULLETIN 6
25 May 2016	BULLETIN 11
17 Jun 2016	BULLETIN 13
27 Jul 2016	BULLETIN 15
25 Aug 2016	BULLETIN 16
29 Sep 2016	BULLETIN 17
03 Nov 2016	BULLETIN 18
12 Jan 2017	BULLETIN 20

Seal / Signature

**29 SEPTEMBER 2017**  
ISSUED FOR FINAL  
RECORD SET

**KEY PLAN**

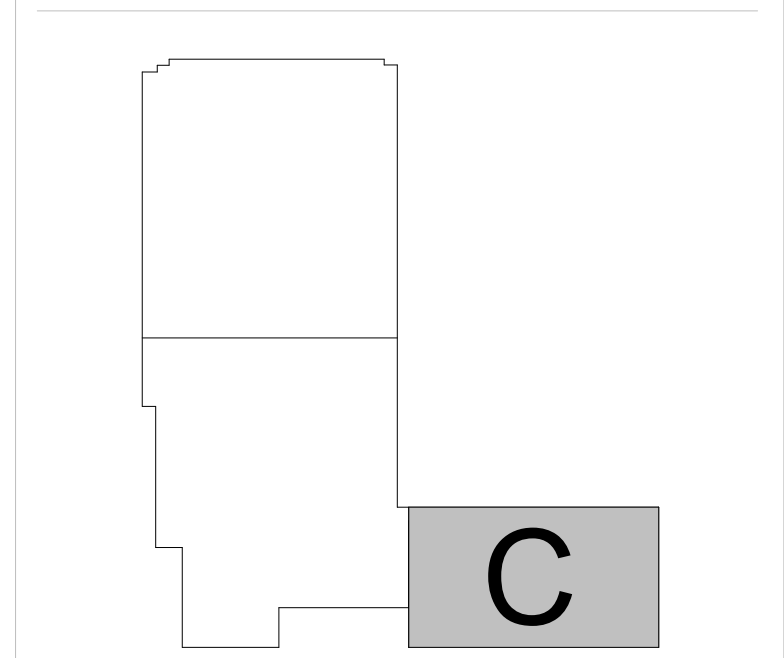

<b>Project Name</b>	McCormick Place HQ Hotel	14400
<b>Project Address</b>	2121 South Prairie Avenue Chicago, IL 60616	
<b>Scale</b>	1/8" = 1'-0"	
<b>Description</b>	FLOOR PLAN - LEVEL LL1A - SEGMENT C	

**A1.10LL1C**