

1 CONSTRUCTION PLAN - LEVEL LL1 - SEGMENT A
SCALE: 1/8" = 1'-0"

KEYNOTES

- 005 LIQUID APPLIED TRAFFIC COATING
- 025 CONCRETE FILLED PIPE COLLARD
- 063 HOSE BIB, SEE PLUMBING DWGS LOCATED 60' AFF
- 737 WATERPROOFING SYSTEM AT BASEMENT SLAB AND WALLS
- 764 FLOOR DRAIN, REFER TO PLUMBING DRAWINGS

- City Stamp**
- Metropolitan Pier and Exposition Authority**
301 East Cermak Road, Chicago, IL 60616
- McCormick Place HQ Hotel**
2121 South Prairie Avenue, Chicago, IL 60616
- Goettsch Partners**
Architect
224 South Michigan Avenue, Suite 1700, Chicago, IL 60604
- Simeone Deary Design Group**
Interior Design
605 North Michigan Avenue, Suite 300, Chicago, IL 60611
- Magnusson Klemencic Associates, Inc.**
Structural Engineer
111 South Wacker Drive, Suite 3390, Chicago, IL 60606
- F.E. Moran**
Mechanical Design Build Contractor
226 Carlson Drive, Northbrook, IL 60062
- Cosentini Associates**
Electrical & Plumbing Engineer
1060 West Division Street, Chicago, IL 60642
- Great Lakes Plumbing and Heating**
Fire Protection Design Build Contractor
4521 West Diversy Avenue, Chicago, IL 60639
- Gibson**
Audio Visual, Security, & Telecommunications
3100 Woodstock Drive, Downers Grove, IL 60515
- Moody Nolan**
Associate Architect / LEED
209 South LaSalle Street, Suite 820, Chicago, IL 60604
- Site Design Group, Ltd.**
Landscape Design
888 South Michigan Avenue, Suite 1000, Chicago, IL 60605
- Terra Engineering, Ltd.**
Civil Engineer
225 West Ohio Street, 4th Floor, Chicago, IL 60654
- Anne Kustner Lighting Design, Ltd.**
Lighting Consultant
900 Isabelle Street, Evanston, IL 60201
- Catt Lyon Design + Wayfinding**
Wayfinding / Graphics
53 West Jackson Boulevard, Suite 362, Chicago, IL 60604
- Ricca Design Studios**
Food Service
5325 South Valerita Way, Greenwood Village, CO 80111
- Klein and Hoffman, Inc.**
Structural & Masonry Engineer (for ABC Building)
150 South Wacker Drive, Suite 1900, Chicago, IL 60606

GENERAL NOTES

- A. ALL WALLS OF DOCK AREA ON LEVEL 01 TO BE CMU.
- B. REFER TO SHEET AS-603 FOR REQUIRED STC RATINGS AT BALLROOM, MEETING ROOM, AND OFFICE PARTITIONS.
- C. REFER TO G3 SERIES DRAWINGS FOR EGRESS AND OCCUPANCY PLANS.
- D. SEE LANDSCAPE DRAWINGS FOR SIDEWALK SCORING COLOR AND FINISH.
- E. SEE CIVIL DRAWINGS FOR SITE ELEVATIONS, DRIVEWAY AND CURB SECTIONS, AND UTILITY INFORMATION.
- F. SEE CIVIL DRAWINGS FOR SIDEWALK HYDRANTS AND HOSE BIB LOCATIONS.
- G. SEE ELECTRICAL DRAWINGS FOR PLANTER RECEPTACLES.
- H. KITCHEN EQUIPMENT SHOWN FOR REFERENCE ONLY. REFER TO FOOD SERVICE DRAWINGS.
- I. SEE FOOD SERVICE DWGS FOR EQUIPMENT BASE LOCATIONS WHERE REQUIRED. GC TO PROVIDE CONCRETE FILL AT EQUIPMENT BASE LOCATIONS.
- J. DESIGNER/OWNER TO ENSURE ALL WALLS AND/OR CEILINGS ARE PROPERLY REINFORCED TO SUPPORT ALL WALL/CILING FOOD SERVICE EQUIPMENT. SEE FOOD SERVICE DWGS.
- K. PITCH FLOORS TO AREA DRAINS IN FOOD SERVICE AREAS. REFER TO FOOD SERVICE DWGS.
- L. REFER TO G3-401 & G3-402 FOR BACK OF HOUSE FINISH SCHEDULE. REFER TO ID DRAWINGS FOR FRONT OF HOUSE FINISH SCHEDULE.
- M. FOR INTERIOR FINISHES REFER TO SHEETS G3-401 AND G3-402.
- N. PROVIDE 6" CONCRETE CURB UNDER ALL FOOD PREPARATION AREA, COMED VAULT ROOM, AND ANY WET AREA PARTITIONS.
- O. PROVIDE FIRE TREATED 4x8x3/4" PLYWOOD AS WALL PROTECTION AND STAINLESS STEEL CORNER GUARDS, AT ALL SERVICE CORRIDORS.
- P. PROVIDE LADDERS AND ACCESS PANELS FOR MECHANICAL MEZANINES AS REQUIRED. PROVIDE HATED PANELS WHERE REQUIRED.
- Q. SEE FOOD SERVICE DWGS FOR ALL REQUIRED SLAB DEPRESSIONS. COORDINATE AS REQUIRED. REFER TO AS SERIES FOR EXTERIOR WALL AND WINDOW INFORMATION FOR ABC BUILDING.
- S. PER SPEC 104413, FIRE PROTECTION CABINETS (FCOPI) TO BE LISTED AND LABELED TO COMPLY WITH REQUIREMENTS IN ASTM E814 FOR FIRE RESISTANCE RATING OF WALLS WHERE THEY ARE INSTALLED.

Date	Description
31 Jan 2016	ISSUED FOR 50% DD
01 Jun 2016	ISSUED FOR 60% CD
01 Aug 2016	ISSUED FOR FULL BUILDING PERMIT
15 Sep 2016	INTERIOR BID SET
07 Oct 2016	FULL BUILDING PERMIT CORRECTIONS
16 Oct 2016	ISSUED FOR 100% CD
20 Nov 2016	BULLETIN 3
31 Dec 2016	BULLETIN 4
22 Jan 2017	BULLETIN 5
25 Mar 2017	BULLETIN 6
29 May 2017	BULLETIN 7
06 Jul 2017	BULLETIN 8
27 Jul 2017	BULLETIN 9
25 Aug 2017	BULLETIN 10

Seal / Signature

29 SEPTEMBER 2017
ISSUED FOR FINAL
RECORD SET

KEY PLAN

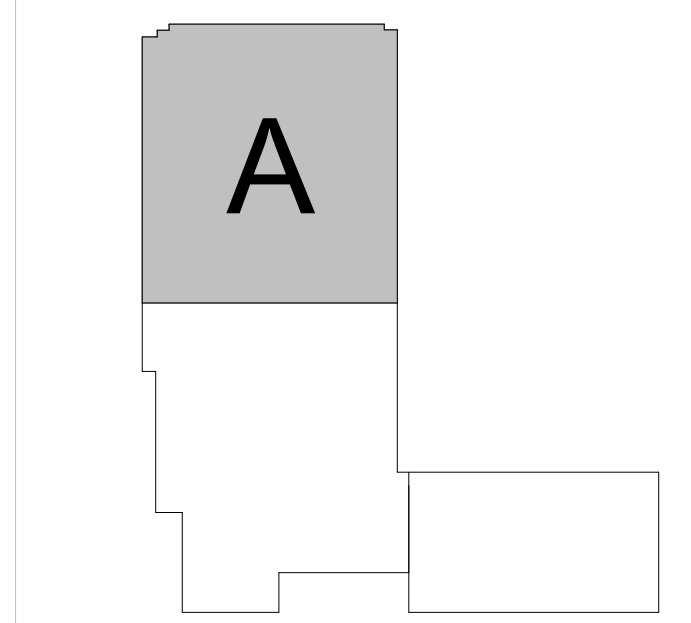

CONST. PLAN LEGEND

- (101) DOOR REFERENCE TYPE SEE SHEET AS-200 - AS-201
- (11) WALL TYPE REFERENCE SEE SHEET AS-600
- (G4) KEYNOTE REFERENCE
- INDICATES POURED CONC. CURB, SEE NOTE N

GRAPHIC SCALES

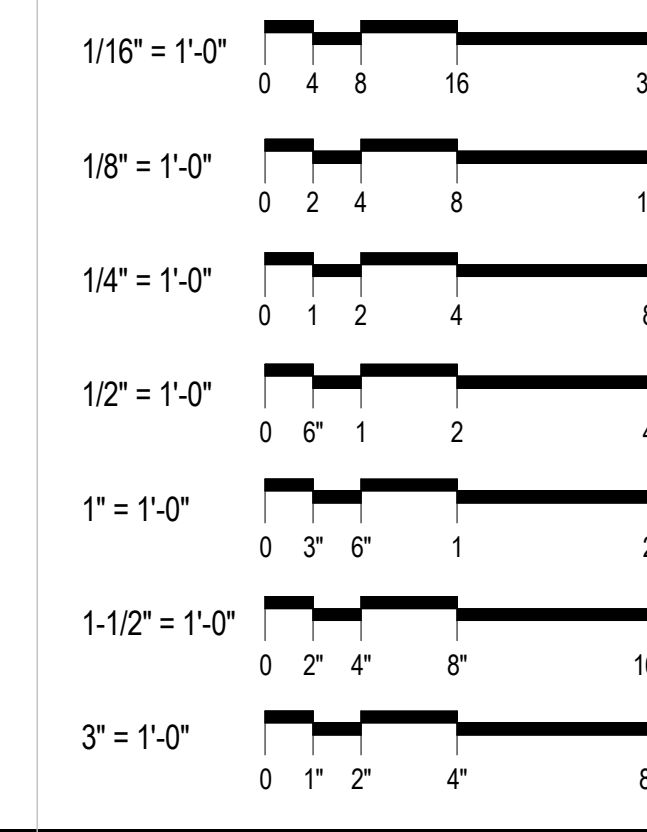

Project Name	McCormick Place HQ Hotel	14400
Project Address	2121 South Prairie Avenue Chicago, IL 60616	
Scale	1/8" = 1'-0"	
Description	FLOOR PLAN - LEVEL LL1 - SEGMENT A	

A1.10LL1A